

The Grange

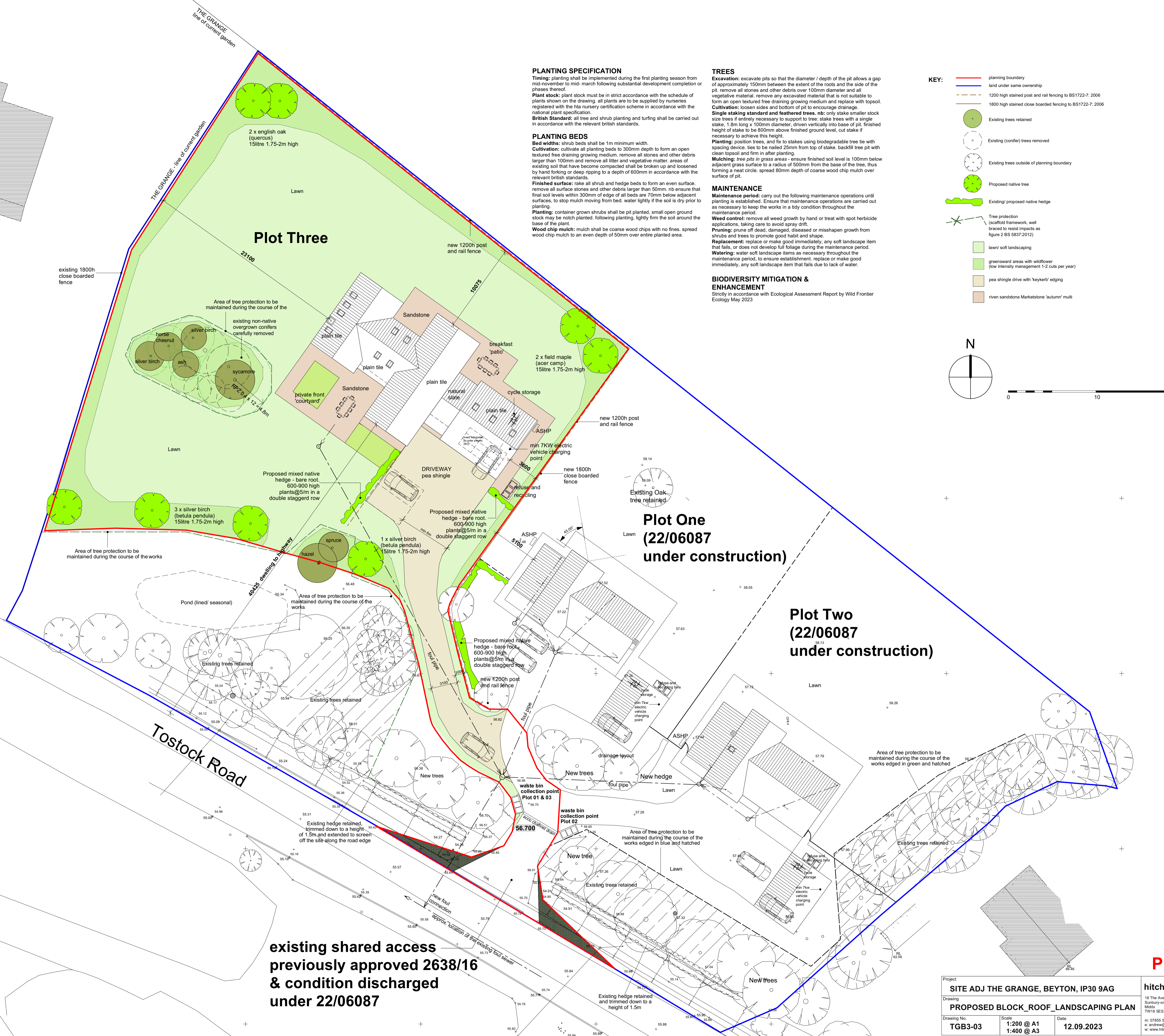

PLANTING SPECIFICATION
Timing: planting shall be implemented during the first planting season from mid-november to mid-march following substantial development completion phases thereof.
Plant stock: plant stock must be in strict accordance with the schedule of plants shown on the drawing. all plants are to be supplied by nurseries registered with the hta nursery certification scheme in accordance with the national plant specification.
British Standards: all tree and shrub planting and turfing shall be carried out in accordance with the relevant british standards.

PLANTING BEDS
Bed widths: shrub beds shall be 1m minimum width.
Cultivation: cultivate all planting beds to 300mm depth to form an open textured free draining growing medium. remove all stones and other debris larger than 100mm and remove all litter and vegetative matter. areas of existing soil that have become compacted shall be broken up and loosened by hand forking or deep ripping to a depth of 600mm in accordance with the relevant british standards.
Finished surface: rake all shrub and hedge beds to form an even surface. remove all surface stones and other debris larger than 50mm. nb ensure that final soil levels within 300mm of edge of all beds are 70mm below adjacent surfaces, to stop mulch moving from bed. water lightly if the soil is dry prior to planting.
Planting: container grown shrubs shall be pit planted, small open ground stock may be notch planted. following planting, lightly firm the soil around the base of the plant.
Wood chip mulch: mulch shall be coarse wood chips with no fines. spread wood chip mulch to an even depth of 50mm over entire planted area.

TREES
Excavation: excavate pits so that the diameter / depth of the pit allows a gap of approximately 150mm between the extent of the roots and the side of the pit. remove all stones and other debris over 100mm diameter and all vegetative material. remove any excavated material that is not suitable to form an open textured free draining growing medium and replace with topsoil.
Cultivation: loosen sides and bottom of pit to encourage drainage.
Single staking standard and feathered trees. nb: only stake smaller stock size trees if entirely necessary to support to tree: stake trees with a single stake, 1.8m long x 100mm diameter, driven vertically into base of pit. finished height of stake to be 800mm above finished ground level, cut stake if necessary to achieve this height.
Planting: position trees, and fix to stakes using biodegradable tree tie with spacing device. ties to be nailed 25mm from top of stake. backfill tree pit with clean topsoil and firm in after planting.
Mulching: tree pits in grass areas - ensure finished soil level is 100mm below adjacent grass surface to a radius of 500mm from the base of the tree, thus forming a neat circle. spread 80mm depth of coarse wood chip mulch over surface of pit.

MAINTENANCE
Maintenance period: carry out the following maintenance operations until planting is established. Ensure that maintenance operations are carried out as necessary to keep the works in a tidy condition throughout the maintenance period.
Weed control: remove all weed growth by hand or treat with spot herbicide applications, taking care to avoid spray drift.
Pruning: prune off dead, damaged, diseased or misshapen growth from shrubs and trees to promote good habit and shape.
Replacement: replace or make good immediately, any soft landscape item that fails, or does not develop full foliage during the maintenance period.
Watering: water soft landscape items as necessary throughout the maintenance period, to ensure establishment. replace or make good immediately, any soft landscape item that fails due to lack of water.

BIODIVERSITY MITIGATION & ENHANCEMENT
 Strictly in accordance with Ecological Assessment Report by Wild Frontier Ecology May 2023

- KEY:**
- planning boundary
 - land under same ownership
 - - - 1200 high stained post and rail fencing to BS1722-7: 2006
 - - - 1800 high stained close boarded fencing to BS1722-7: 2006
 - Existing trees retained
 - Existing (conifer) trees removed
 - Existing trees outside of planning boundary
 - Proposed native tree
 - Existing/ proposed native hedge
 - Tree protection (scaffold framework, well braced to resist impacts as figure 2 BS 5837:2012)
 - lawn/ soft landscaping
 - greensward areas with wildflower (low intensity management 1-2 cuts per year)
 - pea shingle drive with 'keykerf' edging
 - riven sandstone Marketstone 'autumn' multi

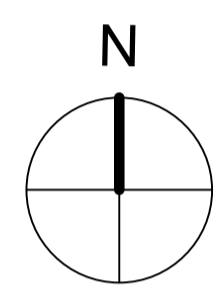

0 10

Tostock Road

existing shared access previously approved 2638/16 & condition discharged under 22/06087

Plot One (22/06087 under construction)

Plot Two (22/06087 under construction)

PLANNING

Project	SITE ADJ THE GRANGE, BEYTON, IP30 9AG		hitchcock architects ltd
Drawing	PROPOSED BLOCK_ROOF_LANDSCAPING PLAN		18 The Avenue Sudbury-on-Thames Middx TW16 5ES
Drawing No.	Scale	Date	m: 07855 522478 e: andrew@hitchcockarchitects.co.uk w: www.hitchcockarchitects.co.uk
TGB3-03	1:200 @ A1 1:400 @ A3	12.09.2023	h ^a